

# FARRIS, HANSEN & ASSOCIATES, INC.

ENGINEERING — ARCHITECTURE — SURVEYING  
7 RIDGWAY COURT — P.O. BOX 437 — ELKHORN, WISCONSIN 53121  
PHONE: (262) 723-2098 FAX: (262) 723-5886

## PLAT OF SURVEY

LOTS 44 & 45 GLENWOOD TERRACE  
LOCATED IN THE NE 1/4 OF THE NE 1/4 SEC. 23  
TOWN 1 NORTH, RANGE 16 EAST  
VILLAGE OF FONTANA—ON—GENEVA LAKE  
WALWORTH COUNTY, WI.

— WORK ORDERED BY —  
SUSAN KOLAR  
3419 REDWING DRIVE  
NAPERVILLE, IL. 60564

ASSIGNED NORTH LINE LOT 44 & 45  
N 87°28'00" E

Lots 44 and 45 in Glenwood Terrace, according to the recorded plat thereof. Said land being in the Village of Fontana, County of Walworth, State of Wisconsin.  
FOR INFORMATIONAL PURPOSES ONLY:  
Property Address: 542 Berwyn Dr, Fontana, WI 53125  
Tax Key Number: SGT 00016

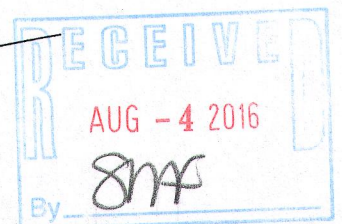

### LEGEND

- = FOUND IRON PIPE STAKE
- = FOUND IRON REBAR STAKE
- ⦿ = SET IRON REBAR STAKE
- (XXX) = RECORDED AS

NOTE: COPIES OF THIS MAP TO WHICH THE FOLLOWING CERTIFICATE WILL APPLY SHOW THE SURVEYOR'S ORIGINAL SEAL AND SIGNATURE IN RED INK. COPIES BY ANY OTHER MEANS MAY HAVE ALTERATIONS WHICH DO NOT REPRESENT THE SURVEYOR'S WORK PRODUCT.

I HEREBY CERTIFY THAT THE ABOVE DESCRIBED PROPERTY HAS BEEN SURVEYED UNDER MY DIRECTION AND THAT THE ABOVE MAP IS A TRUE REPRESENTATION THEREOF AND SHOWS THE SIZE AND LOCATION OF THE PROPERTY, ITS EXTERIOR BOUNDARIES, THE LOCATION OF ALL VISIBLE STRUCTURES, AND DIMENSIONS OF ALL PRINCIPLE BUILDINGS THEREON, BOUNDARY FENCES, APPARENT EASEMENTS, ROADWAYS, AND VISIBLE ENCROACHMENTS, IF ANY. THIS SURVEY IS MADE FOR THE USE OF THE PRESENT OWNERS OF THE PROPERTY, AND ALSO THOSE WHO PURCHASE, MORTGAGE, OR GUARANTEE THE TITLE THERETO WITHIN ONE YEAR FROM THE DATE HEREOF.

DATED: MARCH 22, 2016

*Peter S. Gordon*  
PETER S. GORDON P.L.S. 2101

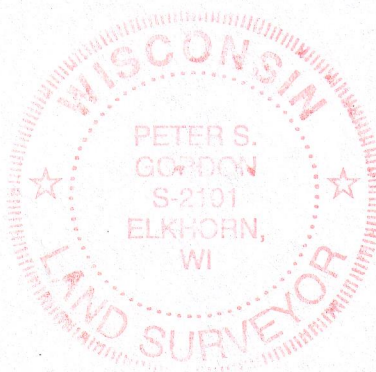

PROJECT: 9489  
DATE: 03-22-2016  
SHEET 1 OF 1